

LED FLASHER 6 LED
CODE 1201

LEVEL 1

Technical Specifications:

- Power supply : 9VDC.
- Consumption : 12mA.
- Display : 6 LEDs.
- Adjust flashing speed with potentiometer.
- PCB dimensions : 2.04 x 1.60 in.

Soldering Components:

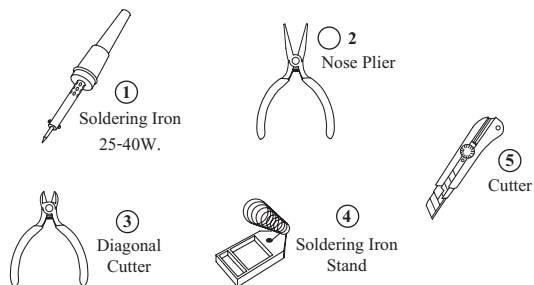

How to Soldering:

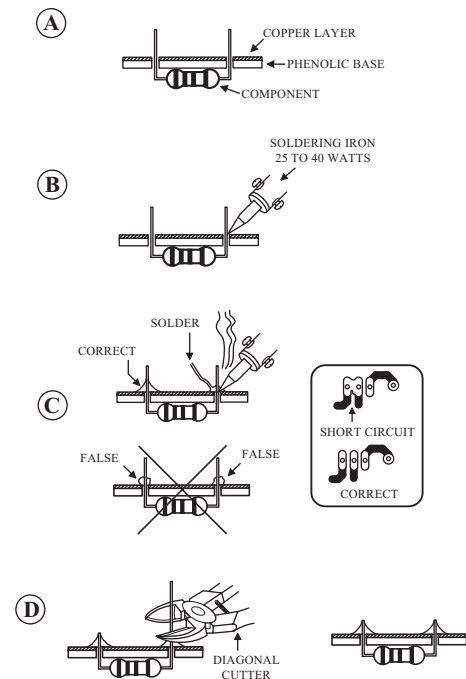

Component Installing

It is to be noted that soldering have to be made after finished each step.

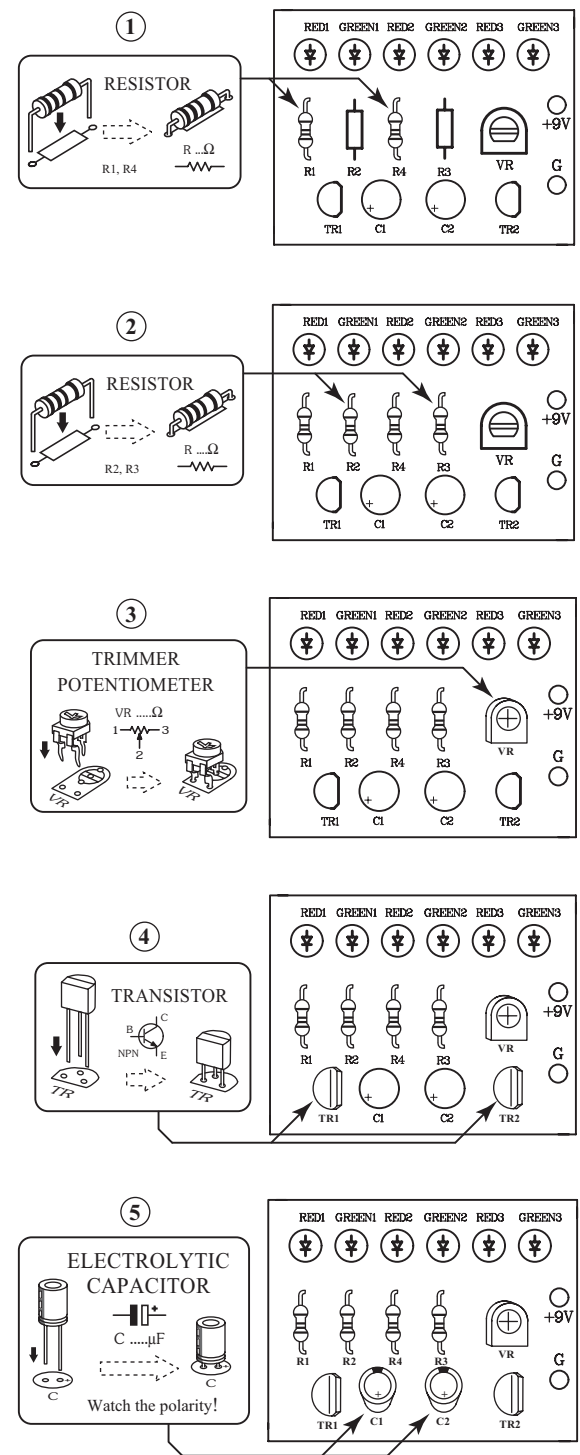

Component Installing (Continued)

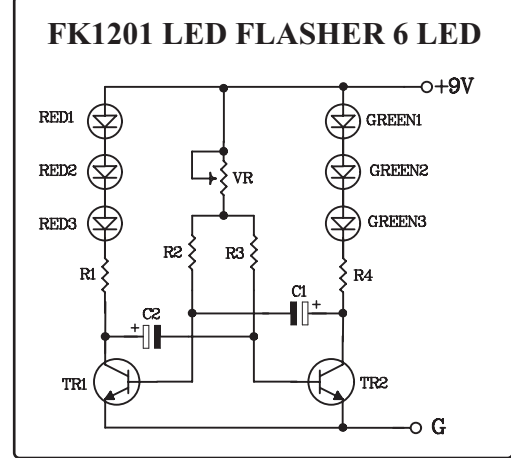
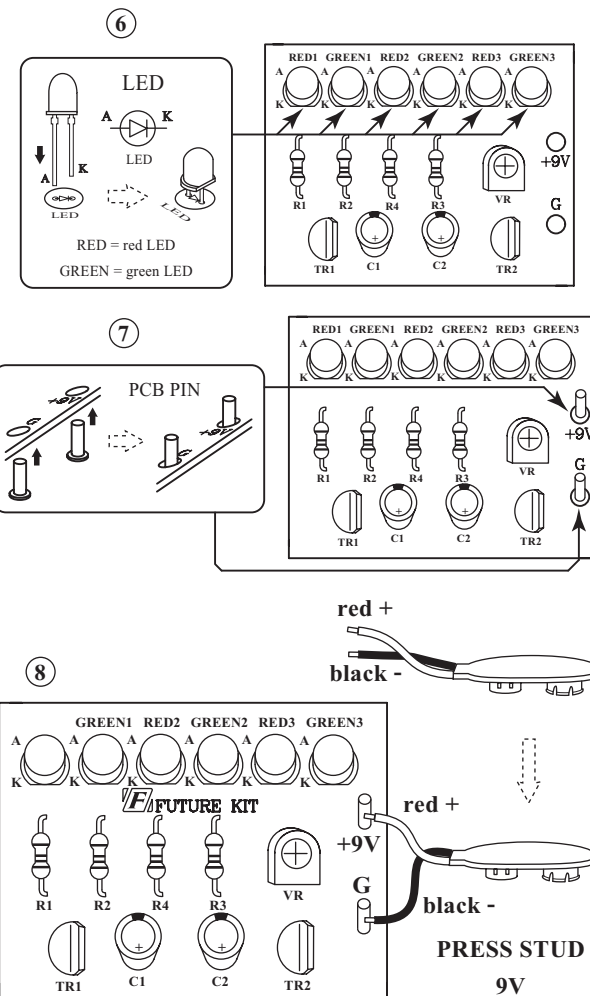

Testing

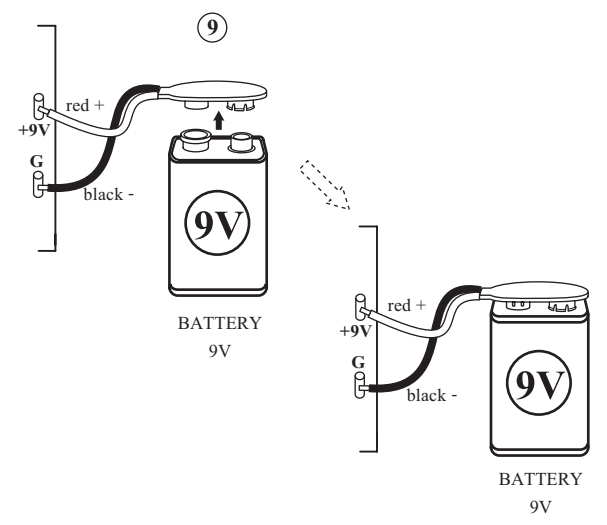

Adjust Flashing Speed

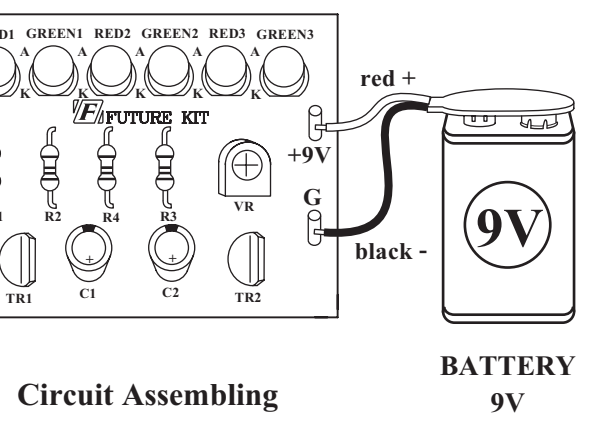
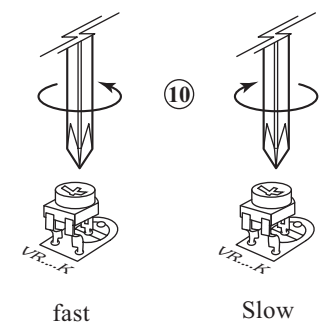

Circuit Assembling

BATTERY 9V

FK1201-1